

TORO

Count on it.

EVOLUTION® Series Add-On: *EVO-SC Smart Connect® Installation*

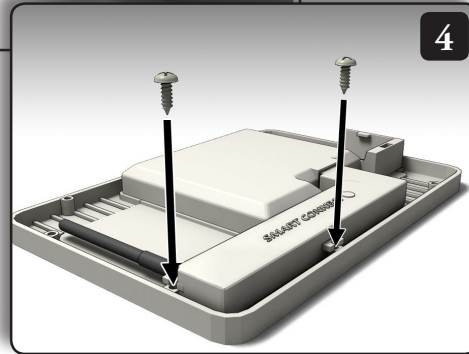
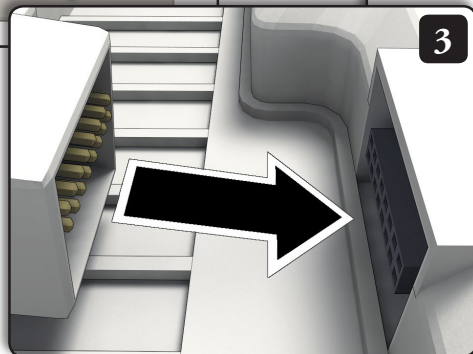
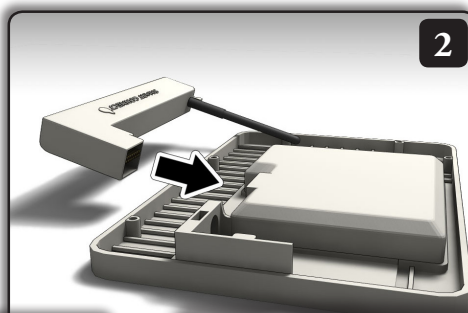
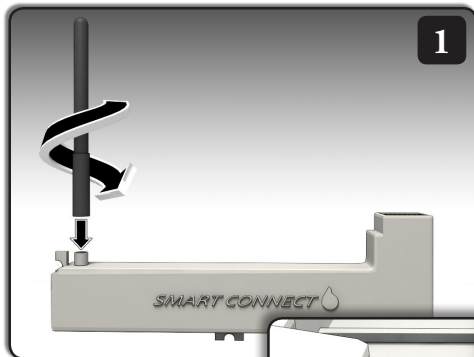

For more information on the EVOLUTION controller and integrated accessories, please go to www.toro.com/evolution (US and Canada) or www.toroevolution.com (international).

Technical Information

Specifications

- Dimensions:
6.5" (16,5 cm) wide x 6" (15,2 cm) high (over 3.75" [9,5 cm] antenna x .75" (1,9 cm) deep
- receives power from controller
- RF reception range:
500'-1000' (152-305 m) LOS (line of sight)
depending on equipment used
- Operating temperature range:
14° – 140° F (-10°– 60°C)



FCC-ID: OF7ESC
IC: 3575A-ESC

FCC Part 15 Rules

This equipment has been tested and found to comply with the limits for a Class B digital device, pursuant to Part 15 of the FCC Rules. These limits are designed to provide reasonable protection against harmful interference in a residential installation. This equipment generates, uses and can radiate radio frequency energy and, if not installed and used in accordance with the instructions, may cause harmful interference to radio communications. However, there is no guarantee that interference will not occur in a particular installation. If this equipment generates interference to radio or television reception, which can be determined by turning the equipment on and off, the user is encouraged to try to correct the interference by one or more of the following measures:

1. Reorient or relocate the receiving antenna.
2. Increase the separation between the equipment and receiver.
3. Connect the equipment into an outlet on a circuit different from that to which the receiver is connected.
4. Consult the dealer or an experienced radio/TV technician for help.

The user may find the following booklet prepared by the Federal Communications Commission helpful: "How To Identify and Resolve Radio-TV Interference Problems". This booklet is available from the U.S. Government Printing Office, Washington, DC 20402. Stock No. 004-000-00345-4.

Australian Warranty Statement

This product comes with a manufacturer's guarantee against defects in material and workmanship when used for its intended purpose. Our obligation under this guarantee is limited to the repair or replacement of the product at our discretion for the period stated. In the event of a claim, you must immediately cease using the product and return the product, together with your proof of purchase and an explanation of the fault to the store you purchased it from. All costs associated with the return of the product are the purchasers' responsibility. To process the warranty, the retailer must contact Toro Australia via their representative or the phone number listed below.

Our goods come with guarantees that cannot be excluded under the Australian Consumer Law. You are entitled to a replacement or refund for a major failure and for compensation for any other reasonably foreseeable loss or damage. You are also entitled to have the goods repaired or replaced if the goods fail to be of acceptable quality and the failure does not amount to a major failure.

Toro Australia Pty Ltd, 53 Howards Road, Beverley SA 50091300 130 898,
info.au@toro.com

Technical Support: 1-877-345-8676 (US & Canada)
evolution@toro.com (international)

©2014 The Toro Company, Irrigation Division • www.toro.com
Form Number 373-0812 Rev. B



Accessoire série EVOLUTION® : EVO-SC Smart Connect® – Installation

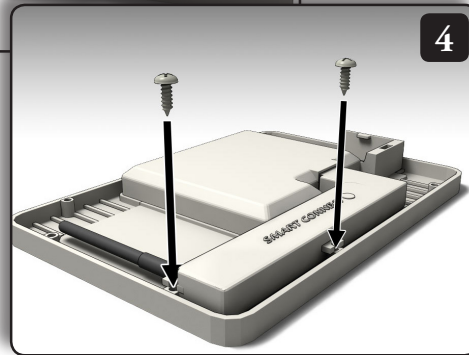
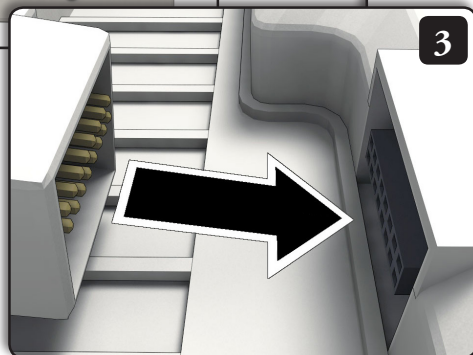
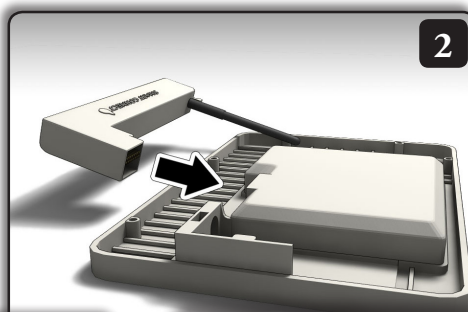
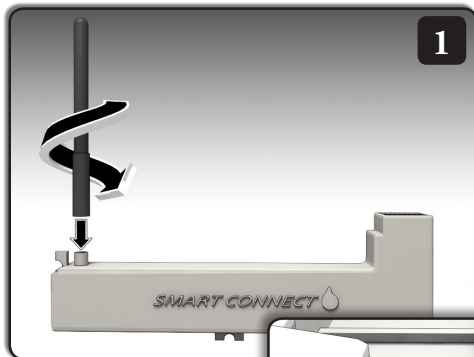

Pour plus d'informations sur le programmeur EVOLUTION et ses accessoires intégrés, rendez-vous sur www.toro.com/evolution (États-Unis et au Canada) or www.toroevolution.com (international).

Informations techniques

Caractéristiques techniques

- Dimensions :
16,5 cm de largeur x 15,2 cm de hauteur (sur une antenne de 9,5 cm) x 1,9 cm de profondeur
- est alimenté par le programmeur
- Plage de réception RF :
152 à 305 m en visibilité directe (LOS), selon l'équipement utilisé
- Plage de température opérationnelle :
-4 °C à 60 °C

Section 15 de la réglementation FCC

Cet équipement a été testé et trouvé conforme aux restrictions imposées aux appareils numériques de Classe B en vertu de la Section 15 de la réglementation FCC. Ces restrictions ont été établies pour assurer une protection raisonnable contre les interférences préjudiciables lorsque l'équipement est utilisé dans une installation résidentielle.

Cet équipement produit, utilise et peut émettre des fréquences radioélectriques et, s'il n'est pas monté et utilisé conformément aux instructions, peut créer des interférences préjudiciables aux radiocommunications. Toutefois, il est impossible de garantir l'absence d'interférences dans une installation donnée. Si cet équipement produit des interférences préjudiciables à la réception radio ou télévision, ce qui peut être déterminé en mettant l'équipement hors tension puis sous tension, nous recommandons à l'utilisateur d'essayer d'y remédier en prenant l'une des dispositions suivantes :

1. Réorienter ou déplacer l'antenne réceptrice.
2. Augmenter la distance entre l'équipement et le récepteur.
3. Brancher l'équipement sur une prise située sur un circuit différent de celui auquel le récepteur est branché.
4. Consulter le distributeur ou un technicien radio/TV expérimenté.

Le livret ci-dessous, préparé par la Federal Communication Commission (FCC – Commission fédérale des communications), peut s'avérer utile pour l'utilisateur : « How to Identify and Resolve Radio-TV Interference Problems » (Comment identifier et résoudre les problèmes d'interférences radio-TV). Cette brochure est disponible à l'adresse suivante : U.S. Government Printing Office, Washington, DC 20402. Réf. 004-000-00345-4.



FCC-ID: OF7ESC
IC: 3575A-ESC

TORO

Count on it.

Zubehör für Serie EVOLUTION®:

Installation des EVO-SC Smart Connect®

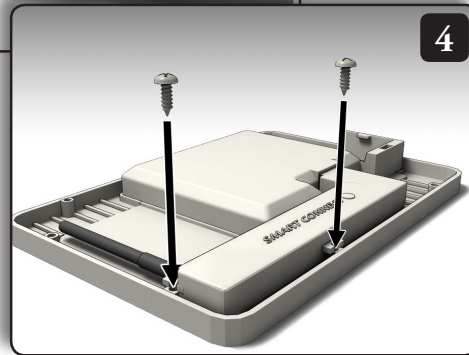
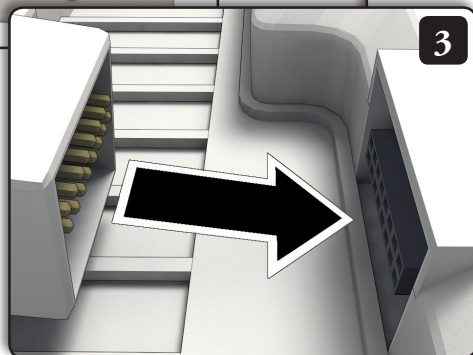
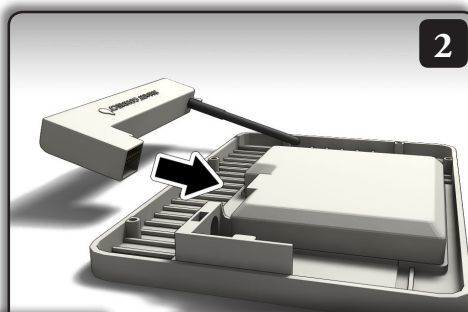
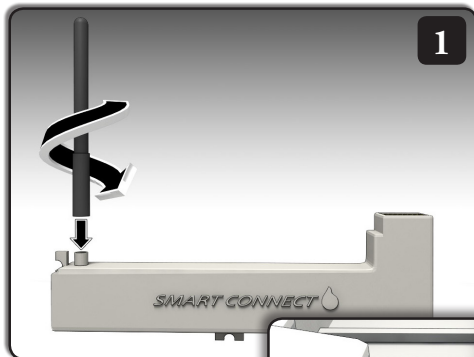

Weitere Informationen zum EVOLUTION-Steuergerät und integriertem Zubehör finden Sie unter www.toro.com/evolution (USA und Kanada) or www.toroevolution.com (international).

Technische Angaben

Technische Daten

- Abmessungen:
16,5 cm Breite x 15,2 cm Höhe (über 9,5 cm Antenne) x
1,9 cm Tiefe
- Wird vom von Steuergerät gespeist
- Funkempfangsbereich:
152-305 m Sichtlinie, abhängig vom verwendeten Gerät
- Betriebstemperaturbereich:
-10 °C bis 60 °C

FCC-Vorschriften, Teil 15

Dieses Gerät wurde getestet und hält die Höchstwerte für ein digitales Gerät der Klasse B ein, gemäß Teil 15 der FCC-Vorschriften. Diese Höchstwerte geben einen angemessenen Schutz vor störenden Interferenzen in einer Privathaushaltinstallation. Das Gerät erzeugt, verwendet und strahlt Hochfrequenzenergie aus, und kann bei unsachgemäßer Installation und Verwendung (kein Einhalten der Handbucharweisungen) den Funkverkehr stören. Es besteht jedoch keine Garantie, dass keine Störungen auftreten werden. Wenn das Gerät den Radio- oder Fernsehempfang stört (dies kann leicht durch Ein- und Ausschalten des Geräts ermittelt werden) sollten Sie versuchen, die Störungen mit folgenden Maßnahmen zu beheben:

1. Richten Sie die Empfangsantenne neu aus oder ändern Sie den Standort der Antenne.
2. Vergrößern Sie den Abstand zwischen dem Gerät und dem Empfangsgerät.
3. Schließen Sie das Gerät an einer Steckdose an, die von einem anderen Kreis als das Empfangsgerät gespeist wird.
4. Wenden Sie sich an den Händler oder einen erfahrenen Radio-/ Funktechniker.

Der Bediener kann u. U. das folgende Blatt nützlich finden, das von der Federal Communications Commission zusammengestellt wurde: „How To Identify and Resolve Radio-TV Interference Problems.“ Dieses Blatt können Sie von folgender Adresse beziehen: U.S. Government Printing Office, Washington, DC 20402.
Stock No. 004-000-00345-4.

Opzione per serie EVOLUTION®: Installazione di EVO-SC Smart Connect®

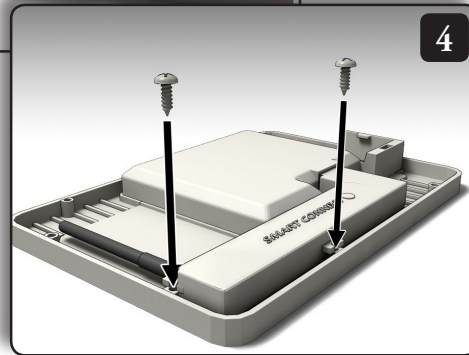
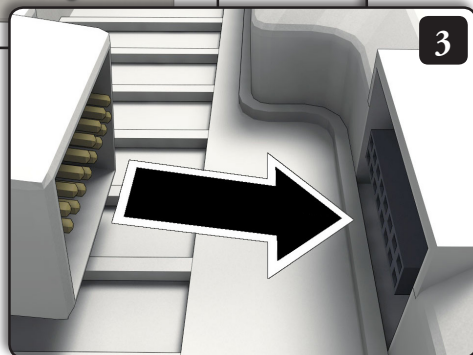
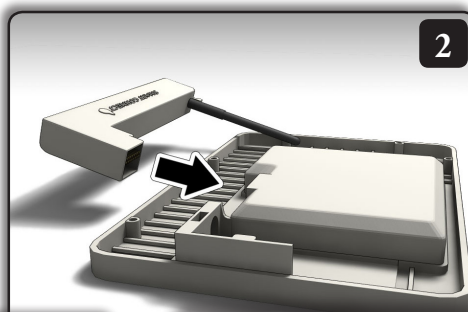
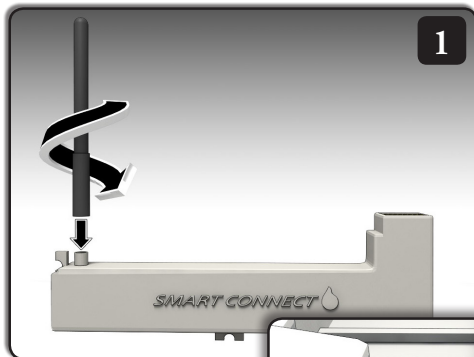

Per maggiori informazioni sul programmatore EVOLUTION e gli accessori integrati, visitate www.toro.com/evolution (USA e Canada) or www.toroevolution.com (internazionale).

Dati tecnici

Caratteristiche

- Dimensioni:
16,5 cm L x 15,2 cm H (oltre l'antenna 9,5 cm) x 1,9 cm P
- è alimentato dal programmatore
- Campo di ricezione RF:
Asse di visione 152-305 m a seconda dell'attrezzatura utilizzata
- Range di temperatura operativa:
da -10 °C a 60 °C

Normative FCC Parte 15

Questa apparecchiatura è stata collaudata e dichiarata conforme alle limitazioni stabilite per i dispositivi digitali di Classe B, conformemente alla Parte 15 delle normative FCC. Tali limitazioni sono state concepite per garantire una protezione ragionevole contro le interferenze dannose quando l'apparecchiatura è utilizzata in un ambiente domestico. L'apparecchiatura genera, utilizza e può emettere energia in radiofrequenza e, nel caso non venisse installata e utilizzata secondo le istruzioni, potrebbe causare interferenze nocive alle comunicazioni radio. Tuttavia, non vi è garanzia che tali interferenze non si verifichino comunque in uno specifico impianto. Qualora l'apparecchiatura generi interferenze dannose alla ricezione radiotelevisiva, rilevabili accendendo e spegnendo l'apparecchiatura stessa, l'utente è invitato a tentare di eliminare tale interferenza adottando una o più delle misure di seguito riportate.

1. Riorientare o riposizionare l'antenna di ricezione.
2. Aumentare la distanza tra apparecchiatura e ricevitore.
3. Collegare l'apparecchiatura a una presa su un circuito diverso da quello a cui è collegato il ricevitore.
4. Richiedere il supporto del rivenditore o di un tecnico radio/TV esperto.

L'utente può trovare utile il seguente opuscolo redatto dalla Federal Communication Commission (Commissione Federale delle Comunicazioni - FCC): "How To Identify and Resolve Radio-TV Interference Problems" ("Come identificare e risolvere problemi di interferenze radio/televisive") disponibile presso U.S. Government Printing Office (Ufficio Stampa del Governo degli Stati Uniti), Washington, DC 20402. Stock n° 004-000-00345-4.

Acessório da série EVOLUTION®

Instalação EVO-SC Smart Connect®

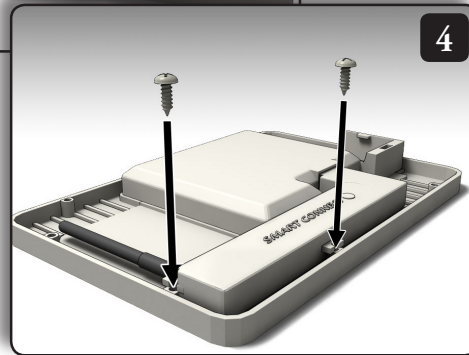
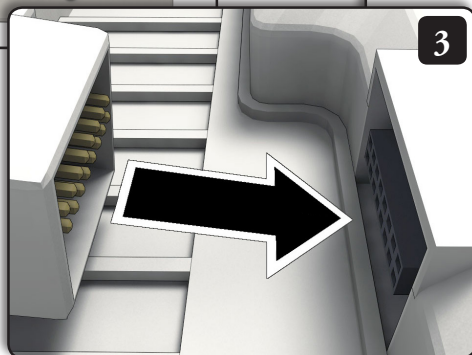
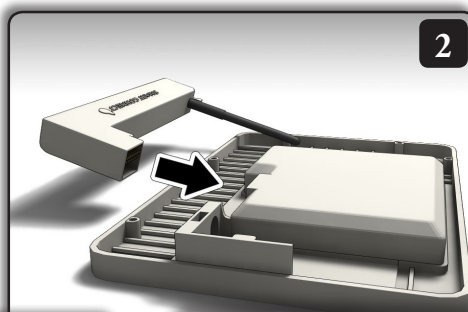
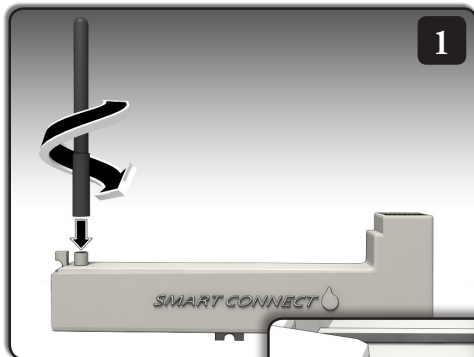

Para mais informações sobre o controlador EVOLUTION e acessórios integrados, visite www.toro.com/evolution (EUA e Canada) or www.toroevolution.com (internacional).

Informação técnica

Especificações

- Dimensões:
16,5 cm largura x 15,2 cm altura (antena mais de 9,5 cm) x 1,9 cm profundidade
- Recebe energia do controlador
- Área de recepção RF:
152–305 m LOS (linha de visão) dependendo do equipamento usado
- Amplitude térmica de funcionamento:
-10 ° a 60 °C

Regras FCC Parte 15

Este equipamento foi testado e considerou-se que está de acordo com os limites para um dispositivo digital Classe B, conforme a Parte 15 das Regras FCC. Estes limites foram concebidos para proporcionar uma protecção razoável contra interferência nociva numa instalação residencial. Este equipamento gera, utiliza e pode irradiar energia de radiofrequência e, se não for instalado e utilizado de acordo com as instruções, pode causar interferências nocivas nas comunicações por rádio. No entanto, não há garantia de que não ocorram interferências numa determinada instalação. Se este equipamento causar interferências à recepção de rádio ou televisão, que podem ser confirmadas pelo ligar e desligar do equipamento, aconselhamos o utilizador a tentar corrigir as interferências, seguindo uma ou mais das seguintes medidas:

1. Reorientar ou relocar a antena de recepção.
2. Aumentar a separação entre o equipamento e o receptor.
3. Ligar o equipamento a uma tomada num circuito diferente daquele ao qual o receptor está ligado.
4. Obter ajuda junto do revendedor ou de um técnico de rádio/televisão experiente.

O utilizador pode considerar útil o folheto preparado pela Federal Communication Commission (FCC): “How to Identify and Resolve Radio/TV Interference Problems” (Como identificar e resolver problemas de interferências em rádio/TV). Este folheto está disponível no U.S. Government Printing Office, Washington, DC 20402.
Stock N.º 004-000-00345-4.



Accesorio para la Serie EVOLUTION®: *Instalación de EVO-SC Smart Connect®*

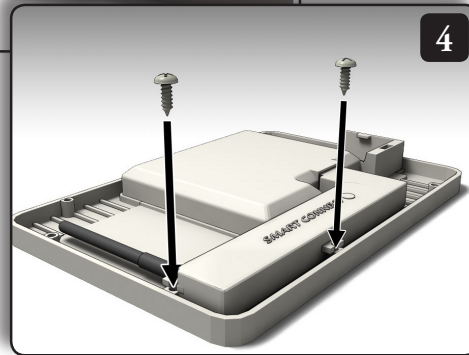
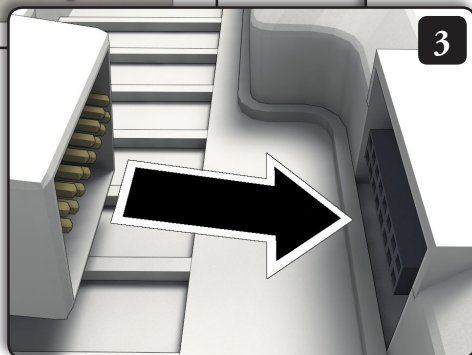
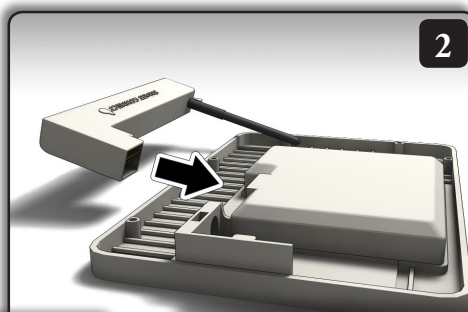
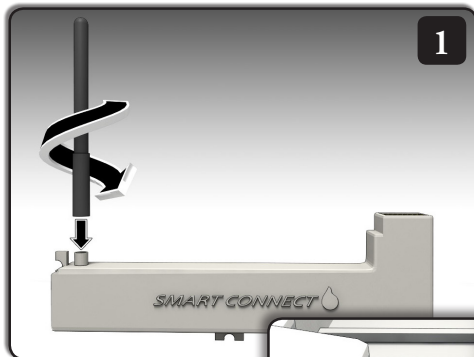

Si desea más información sobre el programador EVOLUTION y los accesorios integrados, visite www.toro.com/evolution (EE.UU. y Canadá) or www.toroevolution.com (internacional).

Información técnica

Especificaciones

- Dimensiones:
16,5 cm (ancho) x 15,2 cm (alto) (antena más de 9,5 cm) x 1,9 cm (profundo)
- Recibe su alimentación del programador
- Alcance de recepción RF:
152-305 m (línea visual directa) dependiendo de los equipos usados
- Intervalo de temperaturas de operación:
-10 °C a 60 °C

Parte 15 de las normas FCC

Este equipo ha sido probado y se ha verificado que cumple los límites de un dispositivo digital de la Clase B, conforme con la parte 15 de la normativa FCC. Estos límites están diseñados para proporcionar protección razonable contra interferencias dañinas en una instalación residencial. Este equipo genera, utiliza y puede radiar energía de radiofrecuencia, y si no es instalado y utilizado con arreglo a las instrucciones, puede causar interferencias dañinas para las radiocomunicaciones. Sin embargo, no podemos garantizar que no se van a producir interferencias en una instalación determinada. Si este equipo genera interferencias en la recepción de radio o televisión (lo que podrá comprobar apagando y encendiendo el equipo), se recomienda al usuario que corrija la interferencia aplicando una o varias de las siguientes medidas:

1. Reorientar o reubicar la antena receptora.
2. Aumentar la separación entre el equipo y el receptor.
3. Conectar el equipo a un circuito eléctrico diferente al del receptor.
4. Consultar al distribuidor o a un técnico experto en radio/televisión.

Es posible que el siguiente folleto elaborado por la Federal Communications Commission (FCC - Comisión Federal de Comunicaciones) pueda resultarle útil: "How To Identify and Resolve Radio-TV Interference Problems" (Cómo identificar y resolver problemas de interferencia en radios/TV). Puede solicitar este folleto a la U.S. Government Printing Office, Washington, DC 20402. N° artículo 004-000-00345-4.



FCC-ID: OF7ESC
IC: 3575A-ESC

Soporte Técnico: 1-877-345-8676 (EE.UU. y Canadá)
evolution@toro.com (internacional)

©2014 The Toro Company, Irrigation Division • www.toro.com
Impreso N° 373-0812-SP Rev. A